

# BILOBA 8010BTJC

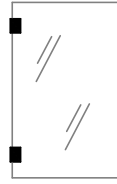

# BILOBA

# 8010BTJC

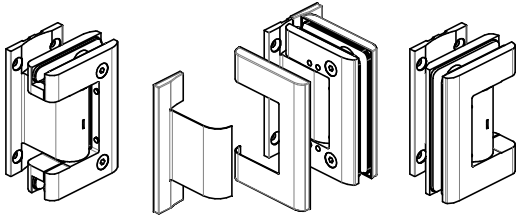

Tools Required  
Strumenti Richiesti  
Benötigtes Werkzeug

Fittings required  
Fissaggi richiesti  
Benötigtes Befestigungsmaterial

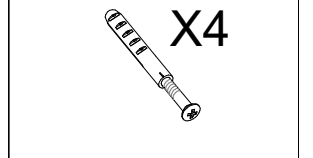
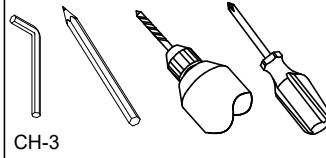

CH-3

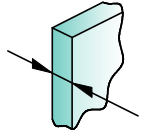
  
8 ÷ 13.52  
GLASS  
VETRO  
GLAS

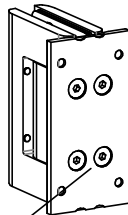

Queste viti sono serrate a 10Nm dalla fabbrica, e' vietato svitarle o allentarle



These screws are tightened at 10 Nm from the factory, it is forbidden to unscrew or loosen them

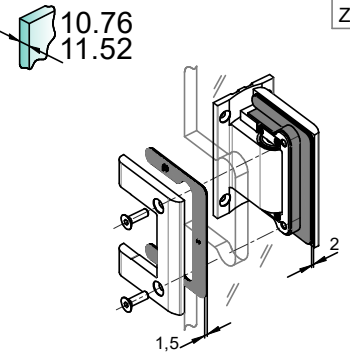
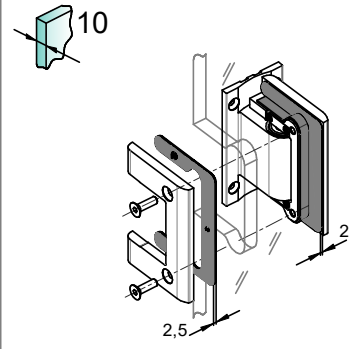
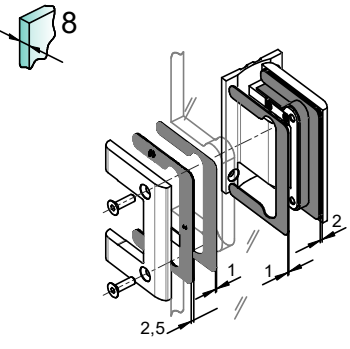

Gasket  
Guarnizioni  
Zwischenlagen

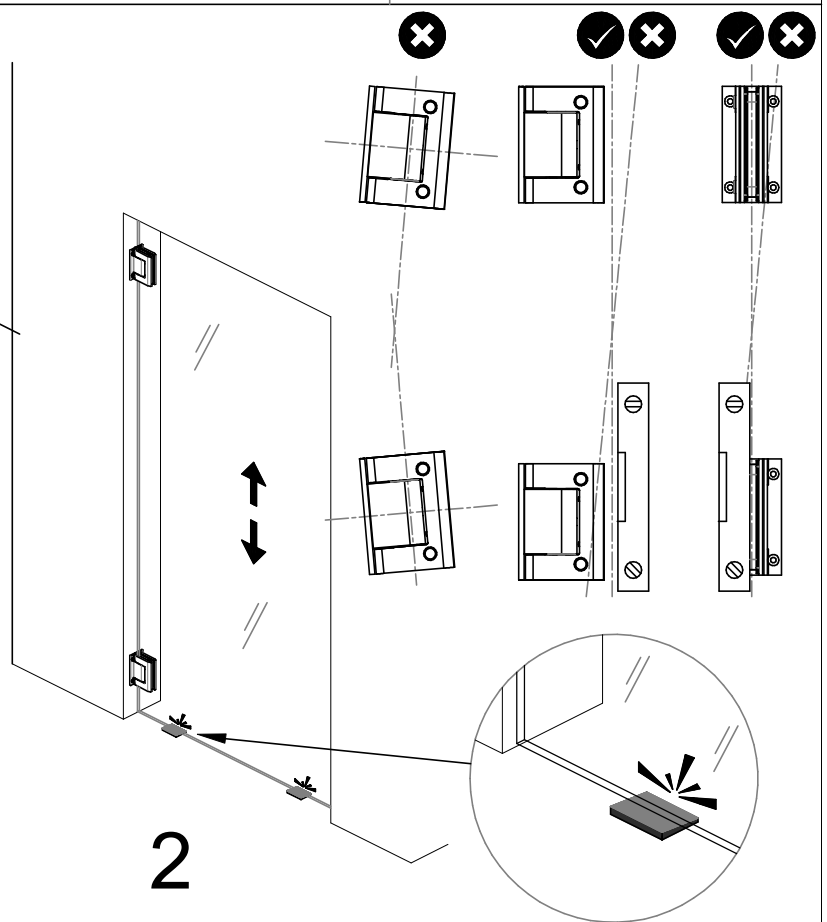
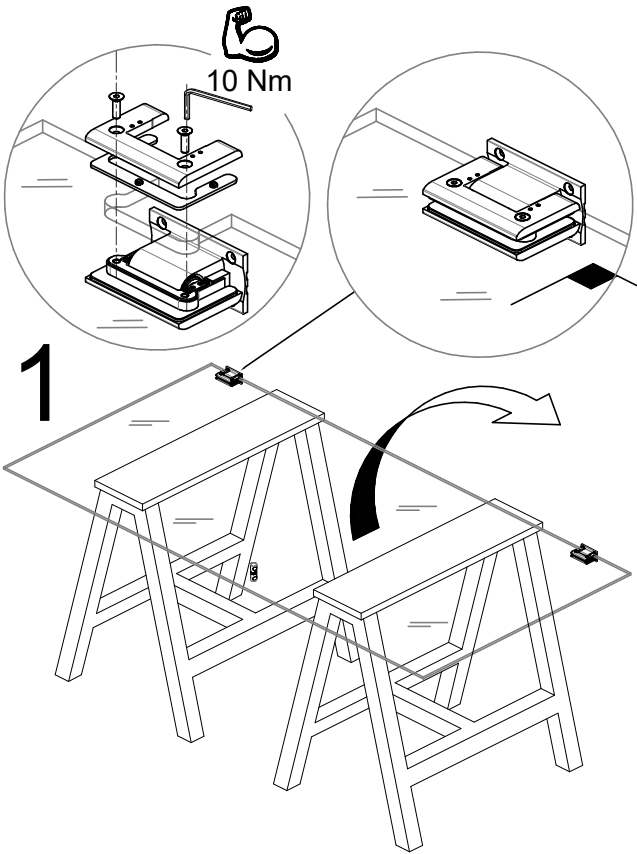
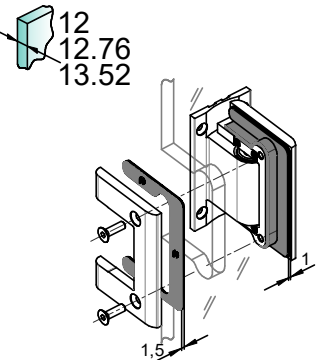

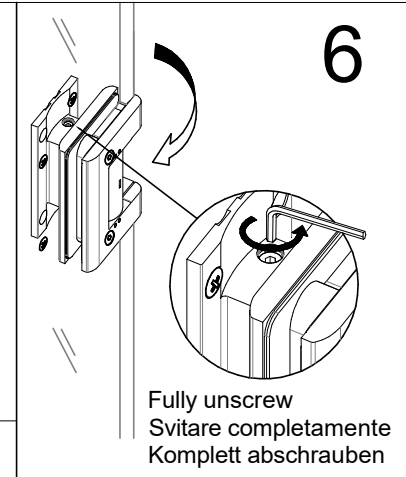
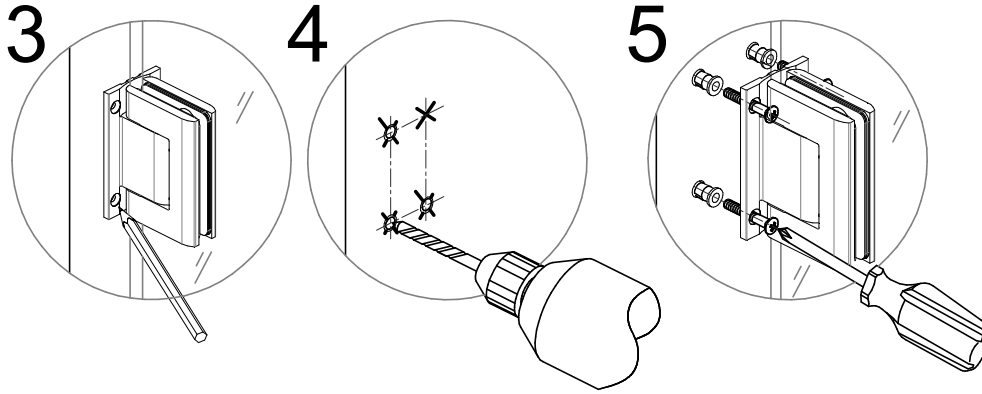

## 7 HORIZONTAL ALIGNMENT FOR EACH HINGE ALLINEAMENTO ORIZZONTALE PER OGNI CERNIERA HORIZONTALE AUSRICHTUNG FÜR JEDES BAND

first REC +  
prima REC +  
erst REC +

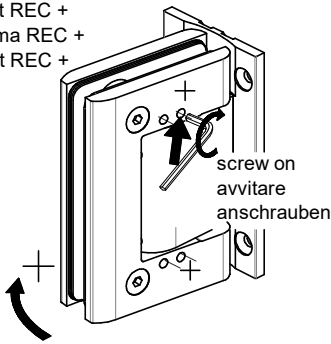

then LOCK  
quindi BLOCCARE  
dann VERSCHLIEßEN

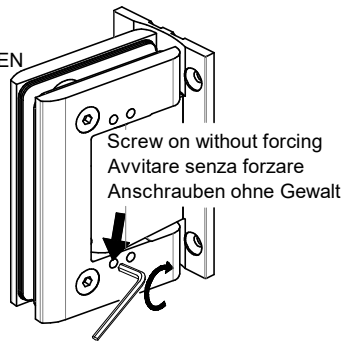

then LOCK  
quindi BLOCCARE  
dann VERSCHLIEßEN

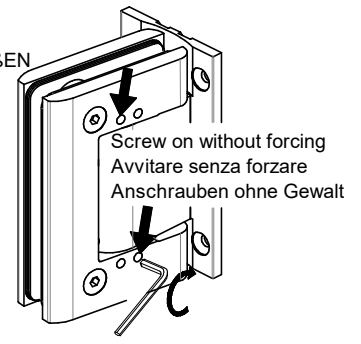

first REC -  
prima REC -  
erst REC -

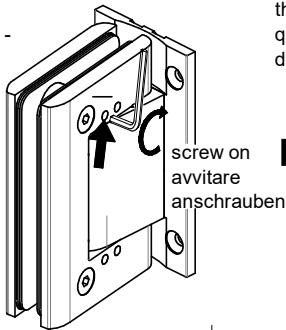

then LOCK  
quindi BLOCCARE  
dann VERSCHLIEßEN

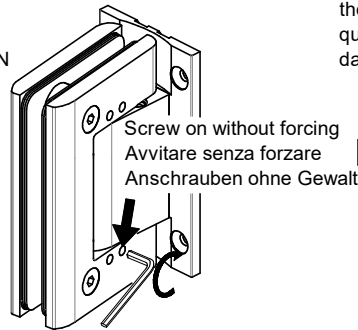

then LOCK  
quindi BLOCCARE  
dann VERSCHLIEßEN

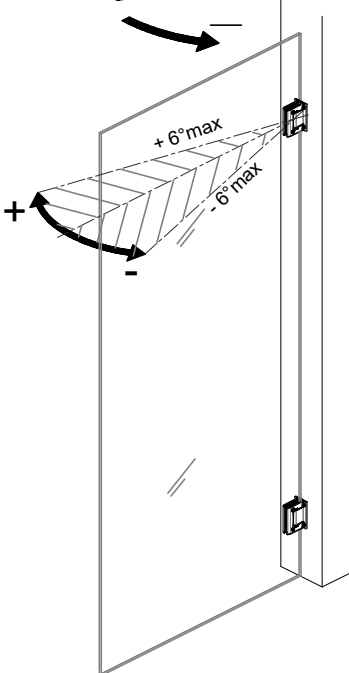
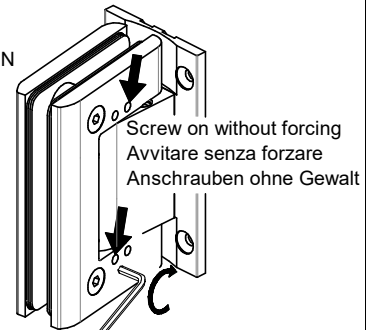

## 8

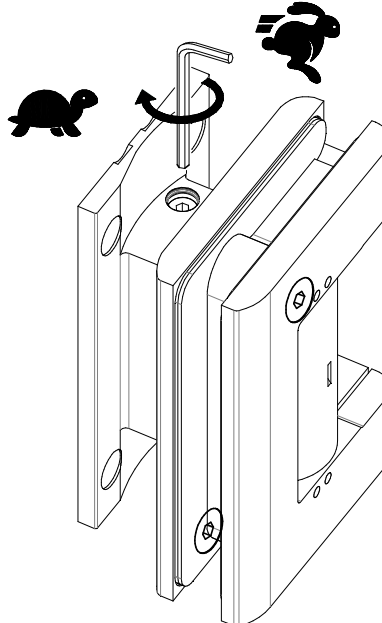

CLOSING SPEED ADJUSTING

REGOLAZIONE TEMPO DI CHIUSURA

EINSTELLUNG SCHLIEßGESCHWINDIGKEIT

Non per la versione SOL  
Not for SOL version  
Nicht für SOL version

K5FB-B; .ACI BHH 9'7CJ9FG'CB@M: HF H 9'<-B; 9G<5J9  
 =ADCFH5BH9'.ACBH5F9'7CD9FHB9'GC@C'8CDC'5J9F'BGH5@5HC'@9'79FB-9F9  
 K-7<H; .56897?IB; 9B'9FGHB57<'ACBH5; 9'89F'6sB89F'5B6F-B; 9B

### %ACI BHB; C: K-B; E'7CJ9F

5ECD9BH9'8CCF'5BS'79BF9H9'7CJ9F'CBH9K-B; E'65G9  
 G@CDB; 'H5GG<CKB'BH9'8F5K-B;  
 6EII G< H9'7IFJ98'D5FHC: 7CJ9F'5BS9EHHF H9@H9DB  
 -BH9'5DDFCDF-5H9G5H  
 7EH9'7CJ9F'G<5@7@7?CBH9K-B; /5'7@7?B; GCIBS  
 G<CKGH9'DFCDF'DCGHCB-B; C: H9'7CJ9F"=: B99898Z  
 <9@DMLFG9@9GK-H 5: @H<958'G7F9K8F-J9F"  
 7%KF9D95HCD9F5HCB5'YX6: CF H9'9CH9F'7CJ9F'5BS  
 7<97? :HG7CFF97HDCGHCB-B;

### ACBH5; ; -C'7CD9FHB55@H5

5E5DF-F9DCFH59'79BF5F9'7CD9FHB5CI @5'65G989@H  
 5@H5-B7@B5B8C@5'7CA985: ; IF5  
 6IGDB; 9F9'@5D5FH9'7IFJ5'8@5'7CD9FHB59: 5F9  
 577CDD-5F9'89EHC'7CB'5DDCGH5'G989  
 7FI CH5F9@5'7CD9FHB59'9A9F9'7CB: CFN55@9'8I9  
 9GH9A-H5G9'B979GG5F-C'5H H5FG=7CBI B'7577-5JH9'D5HC  
 7%KF-D9HF9'CD9F5NCB-5Y6D8F'@5@F5'7CD9FHB59  
 J9F=: 75FB9=@7CFF9HC'DCGNCB5A9EHC

### ACBH5; 956897?IB;

### G9H9HD-@9A9BH

5Ex: : B9B'G9'89H'FIBS@; 9B'8-956897?IB; G7<Fs; 5I:  
 89B: @; 9@K-9'A'G@5; 9N9; H  
 6E8Fy7'9B'G9'89B; 96C; 9B9BH@89F'56897?IB; IBS  
 G9H9B'G9'89B?@B9B'GH H5B'89F'D5G9B89'GH@9'9B  
 7E8-956897?IB; 'CC@H95A: @; 9@7@7?9B/9B  
 ?@7?; 9FsIG7<N9; HB-9F-7<H; 9DCGHCB-9FI B; 89F  
 56897?IB; "K9BB'BxH; Z<9@ 9B'G9'G7<'A'H9-B9A  
 G7<@HNG7<F5I 69B8F9-9F"  
 7%K-989F<C@9B'G9'89B'JCF; 5B; 5IBS'6: yF'8-95B89F9  
 56897?IB; IBSDFy: 9B'G9'89F-7<H; 9DCGHCB-9FI B; "

### & ACI BHB; C: 7CJ9F D5HDE'7CJ9F

5EJ; CFCI G@MI G<-B; @9HH9'7CJ9FG'G9<CC'798'CBH9  
 7CJ9F'D@H9I GB; H9'5DDFCDF-5H9'A5F?G'F9D95H CF  
 6CH 7CJ9FG

### ACBH5; ; -C'7CD9FHB5'7CD9F7<-C

5E79BF5F9'7CD9FHB5'7CA985-AA5; -B9'9FI CH5F@5  
 B9@5'8-F9NCB9-B8-75H585@5; F977-5ZDF9A9B8C'7CB  
 : CFN5: 5F95; ; 5B7-5F9@5'7CJ9F'5@7CD9F7<-CH5A-H9  
 ; @-5DDCGH5; ; 5B7-1F-D9HF9'D9F 9BF5A69@9'7CJ9F

### ACBH5; 956897?IB;

### : @y; 9@H-@9A9BH

5E8Fy7'9B'G9'8-956897?IB; ?Fs: H; ZCC85CG'G9'5A'65B8  
 5B'<57?H

D5HDE'7CJ9F IL&  
 7CD9FHB5'7CD9F7<-C'IL&  
 56897?IB;  
 : @y; 9@H-@9A9BHIL&

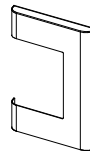

7CAD9HD<-B; 9  
 79FB-9F5'7CAD@H5  
 65B8JC@GH5B8;

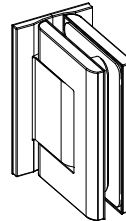

5

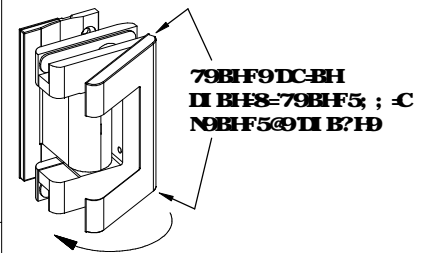

79BF9DC-BH  
 II BH8=79BF5; ; -C  
 N9BF5@DI B?HD

J: CFCI G@MI G<'7@7?'  
 DF9A9F9'7CB: CFN5'7@7?'  
 ?Fs: H; 8Fy7'9B'?'@7?'

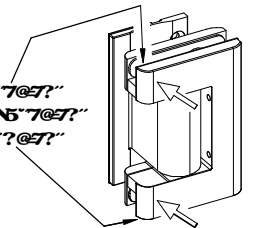

K-B; E'7CJ9F IL&  
 7CD9FHB55@H5 IL&  
 56897?IB;  
 G9H9HD-@9A9BHIL&

5

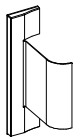

79BF9DC-BH  
 II BH8=79BF5; ; -C  
 N9BF5@DI B?HD

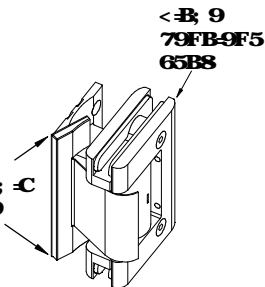

! HC'8CG5A6@9@J9F K-H 5CA5@: @H<958'G7F9K8F-J9F  
 D9F'GACBH5; ; -C: 5F9@9J5'7CB'7577-5JH9'D77C@HGH5  
 D5H5

NA @&G9B'A-H9B9A'G7<@HNG7<F5I 69B9<9F'5B<969B

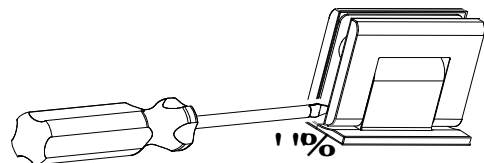

1 10%

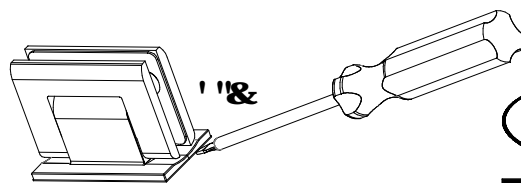

1 10%

